

TREND /4

BEACH BLONDE//

Natural Base///	6
Highlights///	1 part Ice Crème Powder Lightener + 2 parts 6% (20 Vol) Affinage Crème Developer 15g Infiniti 9.035 + 5g Infiniti 9.1 + 30g 6% (20 Vol) Affinage Crème Developer
Root Area///	24g Infiniti 6.036 + 36g 3% (10 Vol) Affinage Crème Developer
Mid lengths & ends///	24g Infiniti 7.036 + 36g 6% (20 Vol) Affinage Crème Developer
Top Panel///	10g Infiniti 8.035 + 15g 6% (20 Vol) Affinage Crème Developer

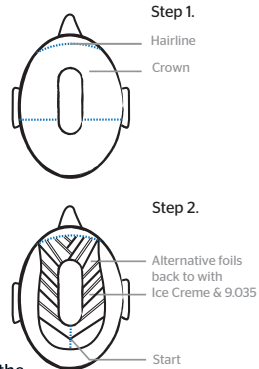

- STEP/ 1/** Section a 1-2 cm (3/8" - 3/4") wide vertical panel of hair from the front of the head to 1 cm (3/8") past the crown, leaving out a fine section at the front/fringe.
- 2/** Take a wider 3 cm (1 1/4") section directly beneath the top panel. Begin at this panel and slice a diagonal forward section starting at the back of the head. Place the slice on a foil and colour with the Infiniti 9.035 colour mix. Work towards the face evenly spacing the sections & alternate Infiniti 9.035 colour mix with a double slice (back to back foils) of Ice Crème.
- 3/** Apply the Infiniti 6.036 colour mix to the root area full head.
- 4/** Immediately apply Infiniti 7.036 colour mix to the mid lengths & ends full head smudging the two colours together where they meet. Colour top panel with Infiniti 8.035 colour mix.

Styling

Spray on Indigo Defender for protection then apply Indigo Smoothie for softness and control. Smooth dry completely with round brush. Prior to using irons for defined movement, apply a light mist of Indigo Enforcer to each section of hair. Iron hair in small triangular sections creating a soft wind swept look. Spritz with Indigo Glazer for gloss.

SHOPPING LIST//



Infiniti
9.035, 9.1, 8.035, 7.036, 6.036



Crème Developer
3% (10 vol) & 6% (20 Vol)



Ice Crème
Powder Lightener



Indigo
Styling & Finishing

AFFINAGE
SALON PROFESSIONAL

affinage.com

For technical information or to contact your nearest distributor call: **UK (+44) 1794 527111 USA (+1) 760 5972929**